

**PARKING AND TRAFFIC ORDINANCE
TOWN OF LIVERMORE FALLS**

**ATTEST: A True Copy of an ordinance entitled "Parking and
Traffic Ordinance for the Town of Livermore Falls" as
certified to me by the Municipal Officers of the Town of
Livermore Falls on the 25th day of August, 1980.**

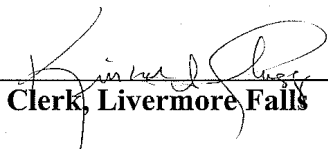

Town Clerk, Livermore Falls

Adopted July 28, 1980
Grace Period for Enforcement
Thru August 25, 1980

Amended September 11, 1980
Amended October 30, 1980
Proposal July 16, 1981
Amended July 30, 1981
Proposal December 18, 1981
Amended December 30, 1981
Amended January 10, 1983
Amended February 21, 1984
Amended January 21, 1985
Amended February 17, 1987
Amended March 02, 1987
Amended March 28, 1988
Amended September 19, 1994
Proposal May 01, 2000
Amended May 15, 2000
Amended July 19, 2004
Amended June 06, 2005

**PARKING AND TRAFFIC ORDINANCE
TOWN OF LIVERMORE FALLS**

- I. Title: This ordinance shall be known and may be cited as the Parking and Traffic Ordinance of the Town of Livermore Falls, Maine.
- II. Authority: This ordinance is adopted pursuant to Title 30 Section 2151 of the Maine Revised Statutes Annotated.
- III. Purpose: This ordinance is designed to update existing parking and traffic regulations thereby allowing better control over vehicle use patterns in Livermore Falls, Maine.
- IV. Intent: The Selectmen of Livermore Falls, Maine shall maintain in said Town suitable parking signs and markings indicating time, manner, and place of parking motor vehicles in accordance with the ordinance, and such additional signs and markings as they may deem necessary to control and direct traffic and parking within the municipal boundaries. No person shall park motor vehicles contrary to this ordinance and such signs and/or markings. Parking and traffic ordinances adopted in the years 1928, 1947, 1955, 1960 and other Town ordinances pertaining to motor vehicle traffic and parking are hereby repealed and superseded by this ordinance.
- V. Definitions:
 1. The designation of Municipal Officer shall mean a majority of the Board of Selectmen.
 2. The word "Parked" as used in this ordinance shall mean allowing a motor vehicle to remain stationary in or on a highway, public way, street, or other public property whether attended or unattended.
 3. Automobile: Automobile shall mean any motor vehicle designed for the conveyance of passengers with a seating capacity of not more than 14 persons.
 4. Motor Truck: Shall mean any motor vehicle designed and used for the conveyance of property, and or passengers.
 5. Motorcycle: Every motor vehicle having a seat or saddle for the use of riding and designed to travel on not more than 3 wheels in contact with the ground, but excluding a farm tractor and a parking control vehicle.
 6. Road Tractor: Shall mean any motor vehicle designed and used for drawing other vehicles and not so constructed as to carry any load thereon either independently or any part of the weight of a vehicle or load so drawn.

7. Bus: Motor vehicles designed for carrying more than 14 passengers and used for the transportation of said passengers for compensation.
8. Semi Trailer: Shall mean any vehicle without motive power designed for carrying persons or property and for being drawn by a motor vehicle and so designed that some part of its weight and/or its load rests upon or is carried by such motor vehicle, and shall include pole dollies, pole dickeys so-called, and wheels commonly used as a support for the ends of logs or other long articles.
9. Motor Vehicle: When the term “motor vehicles” is used in the ordinance it is intended to encompass the types of vehicles defined in sections 3, 4, 5, 6, 7, and 8.

VI. General Regulations:

- Sec.1. No motor vehicle shall be parked within 15 feet of a public hydrant.
- Sec.2. No motor vehicle shall park during specified times in any area marked as loading zones other than vehicles servicing the business (es) immediately adjacent to the loading zone (s).
- Sec.3. No motor vehicle shall be parked:
 - A. On any highway, public way, street, or other public property between the hours of midnight and 6:00 a.m. from the 15th day of November to the 15th day of April of each year; between said dates unoccupied and locked vehicles parked properly within parking spaces in the municipal lot during the designated “No Trespassing” period will be allowed to facilitate snow removal activities;
 - B. so as to obstruct any driveway, crosswalk, private way, street, highway, right of way, public way or other public property;
 - C. in yellow painted zones or along curbing marked in yellow, or in parking spaces marked with yellow paint.

Any motor vehicle parked contrary to the prohibition listed in this section or contrary of any other section of this ordinance shall be subject to removal by the authority of a duly appointed law enforcement officer at the expense of the owner of such vehicle.

- Sec.4. No motor vehicle shall be parked within twenty feet of an intersection or junction of street, highways, public ways, or other public property, except as otherwise may be indicated.
- Sec.5. No motor vehicle shall be parked fully or partially on any sidewalks.

- Sec.6. No motor vehicle shall be parked on any street between any NO PARKING signs.
- Sec.7. No motor vehicle shall be parked overnight or more than 24 consecutive hours in any public parking lot, or on any highway, public way, street, or other public property without written permission of a local law enforcement officer.
- Sec.8. No “U” turn (s) may be made on any highway, public way, street, or other public property except when otherwise designated.
- Sec.9. Motorcycles may at the owners risk be parked singly or 2 or 3 to a marked parking space, provided that no part of the cycles extend outside of the space markings in which case the owner of the cycle in violation may be summoned for improper parking.
- Sec.10.No motor vehicle shall be double parked on any highway, public way, street, or other public property in the municipality.
- Sec.11.Motor vehicles parked parallel with the curb shall be parked within eighteen inches thereof, and within spaces marked therefore, if any.
- Sec.12.The parking and traffic signs and markings provided for by this ordinance and appearing in any street or way in this Town shall be prima facie evidence that such signs and markings were erected and marked in accordance with the provisions of this Ordinance, and by authority of the Selectmen. The map in Appendix A is designed to show the general location of parking and no parking areas. The actual placement of the signs and pavement marking define the areas for enforcement purposes.
- Sec.13.No motor vehicle shall be operated contrary to the posted directions and regulations for entering or exiting municipal parking areas, or parked contrary to said directions or regulations.
- Sec.14.No motor vehicle shall be parked with its left hand side to the curb, except on designated one way streets.
- Sec.15.The Board of Selectmen in responding to parking and traffic problems may establish parking time, or motor vehicle size limitations in any area or zone after notice and hearing. Signs will be posted in areas so limited in such a manner as to notify the public of the limitation.

VII. Specific Regulations

- Sec.1. Parking on Main, Depot, Union, Bridge, and Church Streets shall be limited to the parking spaces provided and areas specifically posted which allow parking.
- Sec.2. Time of parking on the streets listed in Sec.1 shall be limited to one hour from 8:00 a.m. to 6:00 p.m., except on Fridays when this parking limit shall be extended to 9:00 p.m. This section however, shall not be applicable on Sundays or legal holidays nor shall it apply to areas specifically provided with and posted for other time limits based on other sections of this ordinance.
- Sec.3. No motor vehicle shall be parked on the West side of Main Street beginning from a point opposite Gagnon Street to the parking area of Mario's Pizza Shop, and from a point opposite Gordon Street to the corner on Franklin and Main Streets, except duly lined parking spaces falling within said zone.
- Sec.4. No motor vehicle shall be parked on the East side of Main Street from the last designated parking pace adjacent to the Western Auto Store to a point opposite the entrance to the Richard's Garage except for duly lined parking spaces falling within said zone.
- Sec.5. No motor vehicle shall be parked on the West side of Park Street from the intersection of Routes 17 and 133 to the designated point beyond the intersection of Park and Birch Streets, and also from a point marking the northerly boundary line of the Moore Fuel property to a point opposite the southerly property line of the Charles and Anita Alvino residence, and then from a point opposite the northerly corner of the property known as "Alvino's Store" so-called to the intersection of Depot and Park Streets. Any vehicle parked in the area from Alvino's line through Alvino's Store (so-called) must be parked so that it is completely outside of the traveled way as designated by pavement marking lines.
- Sec.6. No motor vehicle shall be parked on the East side of High Street from the intersection of Routes 17 and 133 to the intersection of Depot and Park Streets
- Sec.7. No motor vehicle shall be parked on the East side of High Street beginning from the intersection of High and Upper Depot to a point opposite the intersection the intersection of High and School Streets.
- Sec.8. No motor vehicle shall be parked on the North or South side of Water Street.

- Sec.9. No motor vehicle shall travel in an easterly direction on Millett Street, and Reynolds Avenue, and no motor vehicle shall travel in a westerly direction on Green Street, and no motor vehicle shall travel in a northerly direction on Sewall Street, said town ways being designated as one-way streets.
- Sec.10.No motor vehicle shall be parked on the North side of Millett Street, Green Street, and Reynolds Avenue, and the West side of Sewall Street except in the area from 7 Sewall Street to a location between 9 and 15 Sewall Street.
- Sec.11.No motor vehicle shall be parked on either side of Pleasant Street.
- Sec.12.No motor vehicle shall be parked on the North or South side of Upper Depot Street from the intersection of Pleasant and Depot Streets to the intersection of Sewall and Depot Streets.
- Sec.13.No motor vehicle shall be parked on the North side of Upper Depot from the intersection of High and Depot to a designated point beyond the intersection of Jones Road and Depot Street.
- Sec.14.No motor vehicle shall be parked on the North or South side of Upper Depot Street from the intersection of Pine Avenue and Depot Street to a designated point beyond the intersection of Jones Road and Depot Street.
- Sec.15.No motor vehicle shall be parked on the North or South sides of Depot Street from the intersection of Depot and Pleasant Street to the designated parking spaces in the vicinity of Giguere’s parking lot.
- Sec.16.No motor vehicle shall be parked on either side of Highland Avenue Extension.
- Sec.17.No motor vehicle shall be parked, in the throughway directly to the North and West of the Livermore Falls Police Station exit doors in an area generally described as the traveled way between the northern corner of the Livermore Falls Municipal Building and the Central Maine Power Company Pole 2 and further identified with the placement of “No Parking” signs.
- Sec.18.No motor vehicle other than official Town of Livermore Falls police cruisers shall be parked in either of the two (2) reserved parking spaces directly adjacent to the Town of Livermore Falls police station exit doors which shall be posted “Police Car Only”.

Sec.19.No motor vehicle shall be parked in the 3 designated parking spaces at the southwest corner of the Municipal Building for a period to exceed twenty (20) minutes. This provision shall apply only during normal business hours of the municipal offices, specifically from 8:00 a.m. through 5:00 p.m. Monday through Friday inclusive and excepting legal holidays.

Said designated spaces shall be clearly marked with signs indicating a twenty (20) minute parking limit.

Sec.20.The following locations has been established as No Parking/Tow Away Zones, and should be posted as such.

- A. The intersection of Main Street and Water Street.
- B. From Western Auto to 127 Main Street, with the exception of marked spaces.
- C. The Main Street/Depot Street intersection in front of the Chuck Wagon.
- D. From New England Furniture (Main Street) to Mill Street.

Sec.21.The following area on Cargill, Sewall and High Streets have been designated “No Parking Area”:

- A. Cargill Street on the South side from 17 to 21 Cargill Street.
- B. High Street on the West side from the intersection of School and High Street South to an area between 10 and 12 High Street.
- C. Sewall Street on the East side from the intersection of Depot and Sewall Street to an area between 14 and 16 Sewall Street.

Three maps were included to identify the general area were sign need to be posted.

Sec.22.All School Busses and all trucks with a gross registered weight of 23,000 lbs. or more are prohibited thru use of Water Street.

Sec.23.No Parking is allowed as follows:

- A. the North side of Cedar Street
- B. the South side of Maple, Oak, Walnut, Chestnut, and Birch Streets.
- C. the West side of Highland Avenue.

VIII. Snow Removal

The Road Commissioner is hereby authorized to designate specific roadways and parking areas as Temporary Snow Emergency No Parking Areas. These areas shall be designated by placement of temporary signs indicating the area closed to parking. The Road Commissioner shall cause the signs to be removed as soon as the closing of the area to parking is no longer necessary to facilitate snow removal activities.

The intent and purpose of this article is to facilitate safe, efficient, and timely snow removal activities; these provisions should be liberally interpreted to that purpose.

IX. Penalty: Any person violating any of the provisions of this ordinance shall, if they desire to avoid court action pay the appropriate fees set forth below:

1.	Exceeding time limit	\$ 5.00
2.	Parking within 20' of a crosswalk	5.00
3.	Parking in a No Parking /Tow Away Zone	10.00
4.	Double Parking	10.00
5.	Parking left wheel to curb on a 2 way street	10.00
6.	Obstructing driveway, sidewalk or crosswalk	10.00
7.	Improper parking	5.00
8.	Overnight Parking	5.00
9.	Improper entry or exit	15.00
10.	Nov. 15 to April 15 Restricted area	15.00
11.	Prohibited zone or place	5.00
12.	Within 15' of a fire hydrant	15.00
13.	Parking in Temporary Snow Emergency No Parking Area	5.00
14.	Parking in "Police Car Only" area	5.00

Any person who receives a ticket for a violation of this ordinance and who does not pay the designated fee within 10 day of said violation will be summoned to court for said violation. Payment of the fee within the time allotted obviates court action. In the event of non-payment of said fee a court summons shall be obtained and anyone convicted of a violation of any portion of this ordinance shall be punished by a fine not less than \$25 nor more then \$100, and/or a jail sentence at the Androscoggin County Jail of not more then 10 days.

Upon evidence of payment to the clerk of court prior to the hearing of the appropriate fine set forth in the following schedule the Town may accept said fine and waive court action, through the prosecuting officer.

<u>OFFENSE</u>	<u>VIOLATION</u>	<u>FINE</u>	<u>VIOLATION</u>	<u>FINE</u>	<u>VIOLATION</u>	<u>FINE</u>
1 st	1, 2, 3, 7, 8, 11	\$25	4, 5, 6	\$30	9, 10, 12, 13, 14	\$40
2 nd		35		40		50
3 rd		45		50		60
4 th		55		60		70
5 th		65		70		85
6 th		75		85		100
7 th		85		95		100
8 th		100		100		100

- X. Separability : The invalidity of any provision or portion of this ordinance shall not invalidate any other.
- XI. Effective Date: The effective date of this ordinance shall be the date of adoption by the Board of Selectmen.

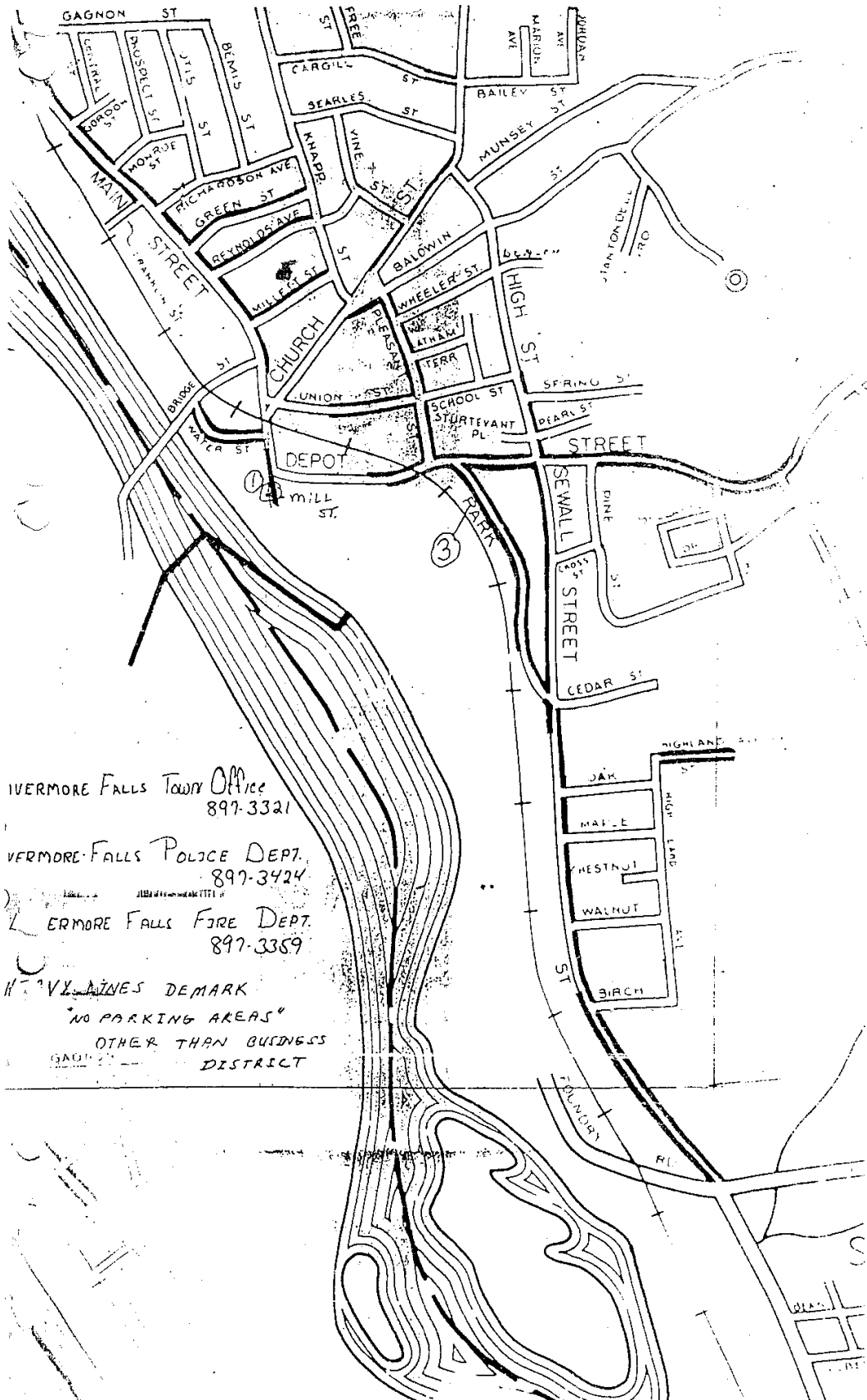

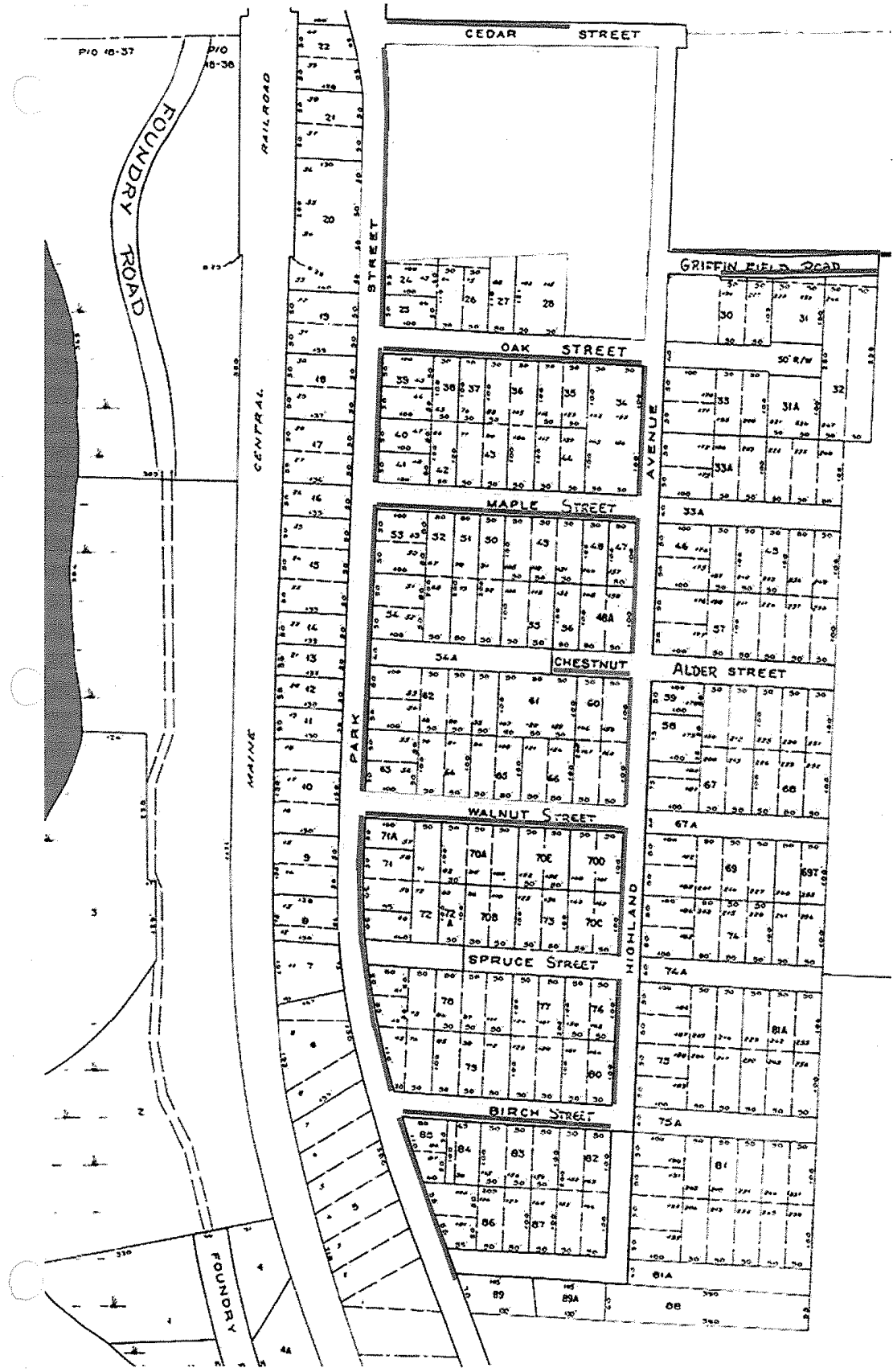

Change Made Sept 17, 1944

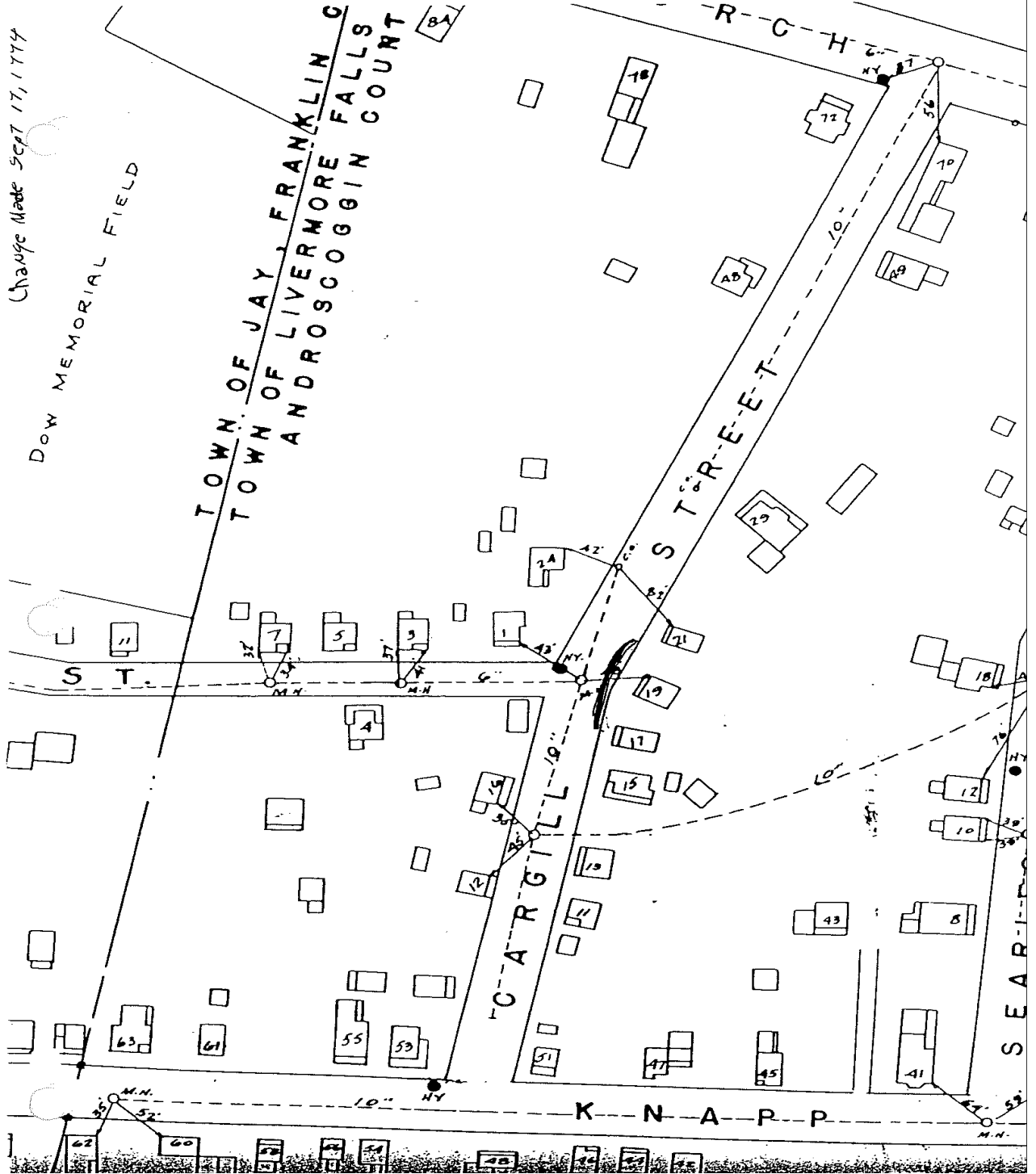

Change Sept 19, 1944

